

精工匠心,卓越智慧——莱纳多高速智能装备,您的理想选择

使命,情怀,担当。助力行业企业发展,引导新旧动能转换——莱纳多智能装备

Seiko ingenuity, excellent wisdom -- Lenado high speed intelligent equipment, your ideal choice

Mission, feelings, responsibility. Help the development of industrial enterprises,
guide the transformation of old and new growth drivers -- Lenado intelligent equipment

Contact us:

LENADO INTELLIGENT EQUIPMENT CO.,LTD

ADD:No.1177 Zhaizishan Road,Qingdao,Shandong,China

Web:<https://www.lenadolooms.com/>

Tel/WhatsApp:+8618661639777 +8613331394313



***textile
machinery***

莱纳多智能织机解决方案

专业 智能织机 遥控管理

+
Lenado
莱纳多



关于我们 About Us⁺

莱纳多智能装备有限公司专业从事智能织机、机器人、伺服驱动器、变频器，智能装备及各类自动化设备的研发、生产销售和服务。

Lenado Intelligent Equipment Co.,Ltd. Specializes in the research and development, production, sales and Service of intelligent looms, robots, servo drives, inverters, Intelligent equipment and various automation equipment.

全世界拥有雇员
Employees worldwide

1000+

生产基地
Production base

80000m²

公司生产车间
Production workshop

40000m²



专业智能织机 遥控管理

Professional intelligent loom remote management



公司是一家拥有自主知识产权的创新型**专精特新企业、高新技术企业**，专业从事智能织机、机器人、伺服驱动器、变频器，智能装备及各类自动化设备的研发、生产销售和服务。公司注重科技创新，已获得三十多项发明专利和实用新型专利。公司核心技术产品目前处于国内领先水平，具有性能优、可靠性高的特点，广泛用于纺织行业，公司产品以达到国际先进水平。

放眼未来，莱纳多智能打造世界一流智能设备为己任，不断创新和超越，成就梦想！

Our company is an innovative, specialized, new and high-tech enterprise with independent intellectual property rights, specializing in the research and development, production, sales and service of intelligent looms, robots, servo drives, frequency converters, intelligent equipment and various automation equipment. The company focuses on technological innovation and has obtained more than 30 invention patents and utility model patents. The company's core technology products are currently at the leading domestic level, with excellent performance and high reliability, and are widely used in the textile industry. The company's products have reached the international advanced level.

Looking to the future, Lenado will create world-class smart devices as its own responsibility, continue to innovate and surpass, and achieve dreams!

企业资质
QUALIFICATION



企业资质
QUALIFICATION



LND9700E高速剑杆绒布织机

LND 9700E high-speed rapier flannelette loom

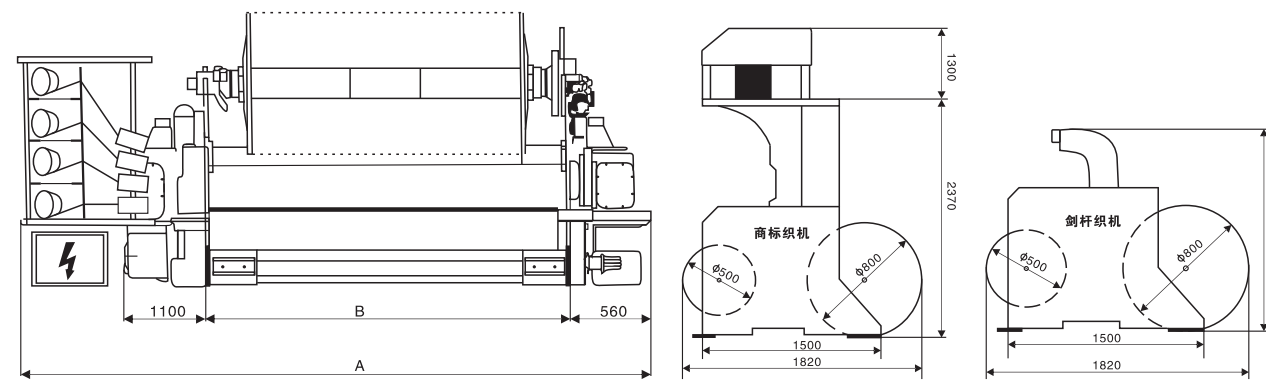
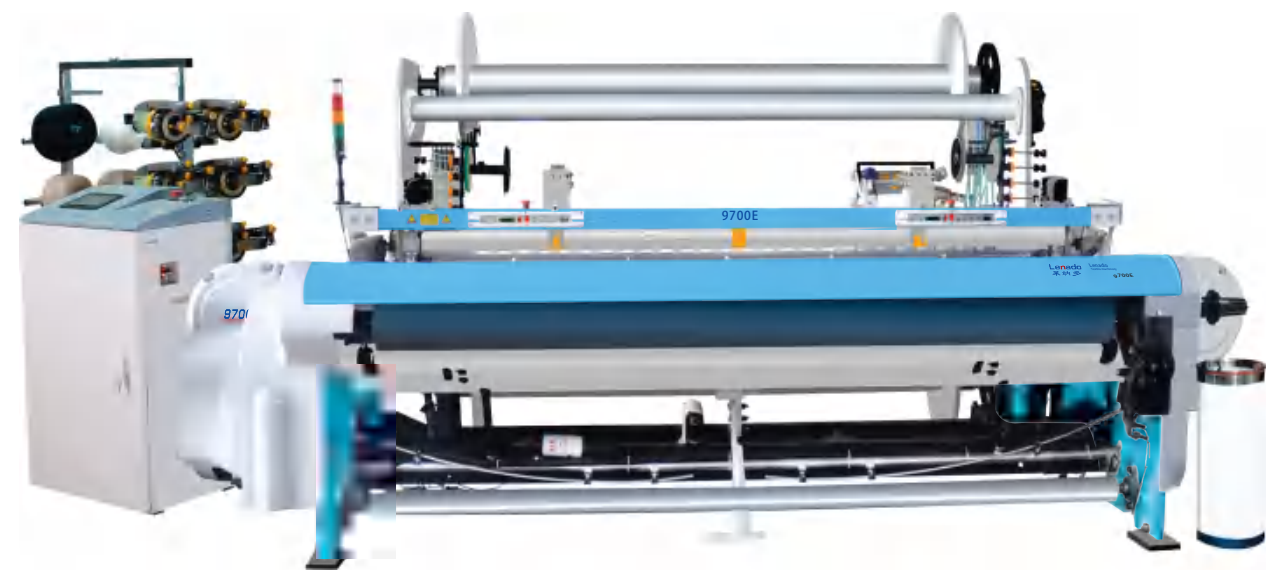

剑杆织机、商标织机外形尺寸：单位mm
Rapier loom Label loom shape size(mm)

公称宽幅 (Nominal width)	A	B
1700	4300	2370
1900	4500	2570
2100	4700	2770
2300	4900	2970
2800	5400	3470
3200	5800	3870
3600	6200	4270
3800	6400	4470

高质量的理想之选！
Ideal for high quality!

莱纳多的高级研发部门、计算机辅助的设计、全球供应策略、ISO9001认证等等，所有这些确保了莱纳多织机能够在任何生产条件下提供最佳制造质量、卓越的可靠性和持久的工作时间。

Lenad's advanced R&D department, computer-aided design, global supply strategy, ISO9001 certification, etc., all of these ensure that W818 looms can provide the best manufacturing quality, excellent reliability and long working hours under any production conditions.

卓越的产品质量！

Excellent product quality!

特殊材质的牢固机架！

莱纳多9700E织机墙板通过超音频淬火，减小了机械震动，采用米汉纳铸铁部件，保证了机械的稳定性。

Special material reliable rack

Lenado 9700E weaving machine side frame passes the ultrasonic frequency quenching, reduces the machine vibration, and adopts with special cast iron parts to guarantee the stability of the machine.

电子技术提高织机的灵活性！

莱纳多9700E机械部件中大部分机器参数为电子设定，机器设定可通过计算机显示器或从其它装置复制，快速，准确地执行，使织造变得极其灵活。

Electronic technology raises the flexibility of the loom

Among the mechanical parts of 9700E, most of mechanical parameters were set by electron. Machine settings make weaving extremely flexible by the way of computer display or copy from other device and run quickly and accurately.

消除了开车痕！

莱纳多9700E机械传动简单有力、可靠。从而使机器快速启动与刹车可在一个循环内完成。从而消除了开车痕。自动开口整平可防止在梭口张开停车时，纱线拉伸所引起的开车痕。送经与卷取的电子链接又为开车。

Prevent operation vestige

An extreme simplification and reliability in the mechanical drive of Lenado 9700E, it makes quick start and brake also can be finished in a circulation and an extraordinary reduction of operation vestige, when the open shedding stops, the automatic shed smooth can avoid the operation vestige of drawing up of electronic link let-off and take-up of the yarns guarantee the prevention for operation vestige.

润滑！

莱纳多9700E织机采用集油站强制关键部位准时、精确的润滑。保证了织机所有可靠性。提高了所有结构的机械效率，可使您以极低的保养维护换取最大的效益，提供给您巨大的竞争优势。

Lubrication

Lenado 9700E loom adopts lubrication station forcibly lubricates the main parts in punctual and precise way and guarantees total reliability, it increases the mechanical efficiency of all the various components, that means great advantages in terms of absolute minimum maintenance, offering you truly great competitive advantages.

电子纬纱、张力自动调控！

织造时，纬纱强度弱，可减少基本张力，送纬时，增加张力，这可避免线环的形成，张力调控使您能以更高的速度织强或弱的纱，还可大大减少断纬的情况。

Electronic weft, self-control tension

When weaving, the intensity of the weft is weak, it can low the basic tension, when let-offing, it adds the tension, it can avoid the forming of the thread ring. The adjustment of the tension can not only weave the strong or weak yarn in higher speed, but also it can minimize the condition of broken Weft.

可变纬密！

9700E上的送、卷装置均为电子驱动。通过人机界面很容易织不同纬密及花样的织物。同时我们考虑到用户操作人员的素养，操作人员很容易掌握。

The changeable weft density

The device of let-off and take-up on Lenado 9700E are all driven by electron. Though the man-machine interface, it is easy to weave the different weft density and fabric patterns. At the same time, we think over the quality of operating personnel of our customers, they grasp it easily.

LND999E高速毛巾剑杆织机

LND 999E high speed terry towel rapier loom



LND999E高速毛巾剑杆织机

LND 999E high speed terry towel rapier loom

公称箱幅: 190, 210, 230, 260, 280, 300, 360, 380 (cm)
Width: 190, 210, 230, 260, 280, 300, 360, 380 (cm)

车速: 300-500RPM (与织物品种和幅宽有关)
Speed: 300-500 RPM (designed by material and width)

起毛高度: 0-12mm
Raising height: 0-12mm

纱支范围: 短纤维Nm4-Nm200, 长纤维tex1.7-tex380
Yarn woven: short fiber Nm4-Nm200, long fiber tex1.7-tex380

品种适用性: 适用于各种毛巾织物的织造
Weaving adaptability: all kinds of terry towel productions

地经送经: 织轴直径Φ800mm
Down warp let-off: weaving beam diameter Φ800mm

毛经机构: 织轴直径Φ1000mm
Up warp let-off: weaving beam diameter Φ1000mm

送经形式: 电子送经
Let-off method: electronic let-off

卷取机构: 电子卷取可选机外大卷装, 最大直径1500mm
Take-up method: electronic take-up
The machine can be installed in large volume, maximum diameter of 1500mm

传动装置: 超级马达, 直接驱动
Drive device: Super motor, direct drive

开口装置: 可配备电子多臂机及电子提花机, 电子多臂机最多配20块综框
Open device: adopt electronic dobby and jacquard loom, 20 pcs heald frames
electronic dobby at most

毛经送经: 毛经送经机构采用电子伺服送经, 独立的电控系统, 便于毛经送经的调节和控制
Up warp let-off: adopt electronic let-off, independent electronic control system,
easy to adjust and control the up warp

起圈: 独特的电子起毛装置, 专利设计
Raising: special electronic raising device and patents designing

变纬密功能: 由电子送经, 电子卷取机构程序设定自动控制, 满足各种毛巾织物的需要
Weft Variability: self control by electronic let-off and electronic take-up, satisfied
vall kinds of terry towel productions

控制与检测: 采用微电脑控制系统, 具有电子送经电子选纬, 自动寻纬, 故障检测, 液晶显示等功能
Control and examine: adopt microcomputer control system, electronic let-off, electronic weft
selecting, automatic wefting, self-check, LCD ect.

LND999E高速剑杆织机
LND 999E high speed rapier weaving machine



使命 / 情怀 / 担当
助力行业企业发展
引导新旧动能转换
——莱纳多智能装备

Mission/Feelings/Responsibility
Facilitate the development of industry enterprises
Guide the conversion of new and old kinetic energy
——Lenado Intelligent Equipment

LND999E高速剑杆织机
LND 999E high speed rapier weaving machine

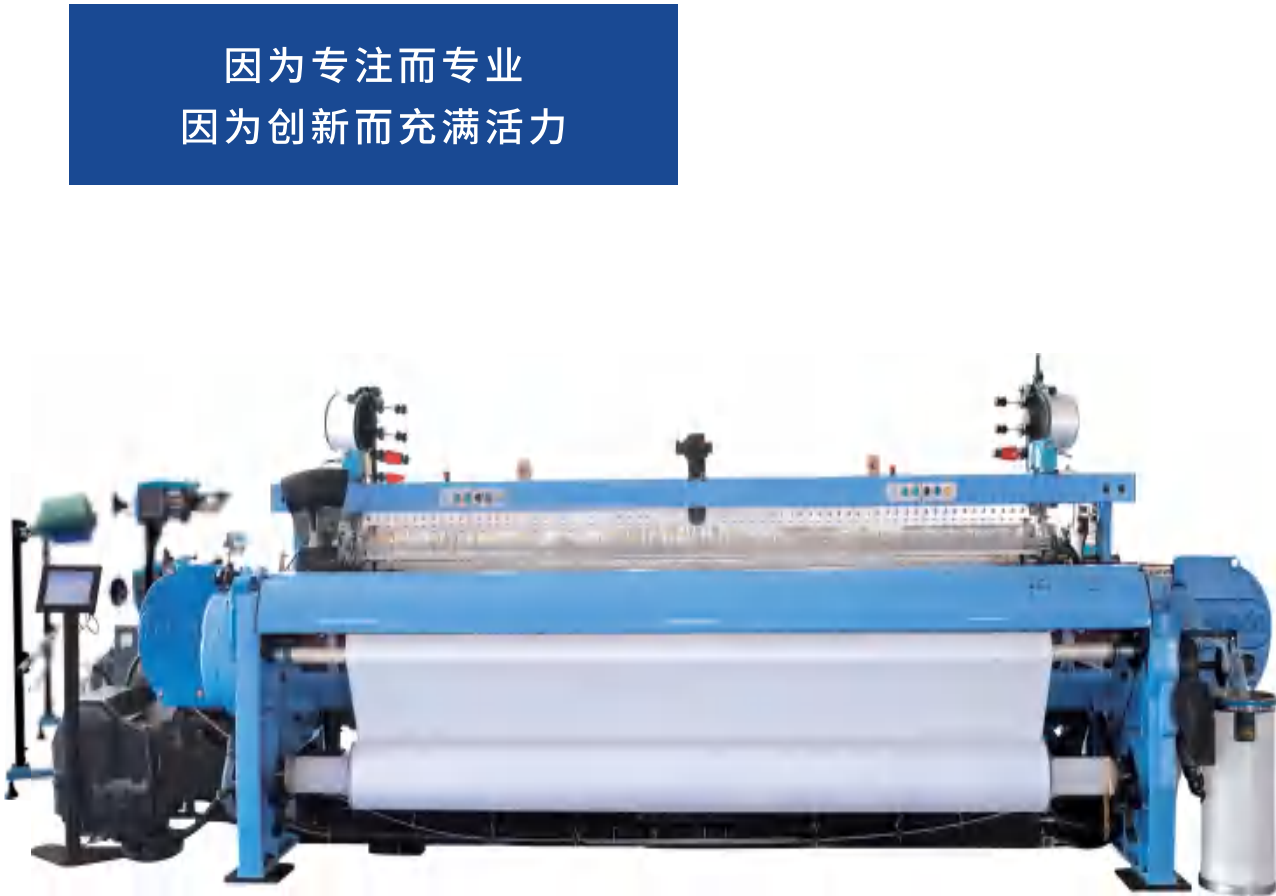

因为专注而专业
因为创新而充满活力

Professional because of focus
Energetic because of innovation

LND999E剑杆织机技术特点

LND 999E rapier weaving machine technical characteristics

织机箱幅	1200-4000毫米
Reed space	1200-4000mm
织机车速	最高每分钟可达车速650转
Speed	650turns per minute
织机润滑	集中自动加油式油脂润滑
Lubrication	Central and automatic lubrication style greaselubricated
选纬机构	8色-12色单纬或双纬织造
Weft selector	8-12colors single or double wefts weaving
纬密范围	直径5-400纬/厘米
Weft density	Diameter 5-400 weft/cm
钢筘传动	双侧驱动共轭凸轮打纬系统
Reed drive	Bilateral drive,conjugated cam battening system
纺机传动	超级马达直接驱动主机及慢速寻纬机构
Machine drive	Super motor direct drive host and slow weft insertion mechanism
传剑方式	单排导钩或无轨式传统传剑方式
Rapier transfer mode	Single row guide hook or no track mode traditional rapier transmission mode
织造范围	适用于织造天然纤维(棉、毛、麻)化学纤维、混纺纱等的织造
The range of weaving	Natural fibers(cotton、wool、hemp)、chemical fiber、blended yarn etc.
自停装置	电子式断经或断纬自动停车
Automatic stop motion	Electronic automatic stop motion if warp breaks or weft breaks
送经系统	载荷传感器控制的送经系统
Let-off motion	Load-sensor control warplet-offsystem
卷取机构	电子控制的卷取系统
Take-up motion	Electronic control take-upsystem
控制系统	液晶屏幕
Control system	Liquid crystal display
监控	自动诊断、停车分布报告
Monitor	Self-diaanosisstopanalysisreport

选配件

Select Accessories

开口机构
Shedding mechanism

提花机
Jacquard machine

多臂机
Dobby

经轴
beam

800mm 直径的螺纹盘
800 mm diameter threaded disc

1000mm 直径的螺纹盘
1000 mm diameter threaded disc

1100mm 直径的螺纹盘
1100 mm diameter threaded disc

折入装置
Folding in device

热切割刀
Hot cutting knife

高温切刀
High temperature cutter

引领纺织企业织出个性化多彩世界！
Leading the textile industry and weaving out the characteristic and colorful world

凭借其卓越的性能，莱纳多9800E剑杆织机可以灵活地织造所有种类的织物。
这款新型织机可以有效的织造八到十二色纬纱的时装面料、装饰布、窗帘布、毛巾、牛仔布以及轻、重磅工业布。它几乎可以织造所有种类的纱线，无论天然纤维、合成纤维、还是化学纤维。

With its excellent performance, Lenado 9800 rapier loom can weave all kinds of fabrics flexibly.
This new loom can effectively weave fashion fabrics, decorative fabrics, curtain fabrics, towels, denim, and light and heavy industrial fabrics with eight to twelve-color wefts. It can weave almost all kinds of yarns, whether natural fibers, synthetic fibers, or chemical fibers.



LND2020E高速喷气织机

LND 2020E high speed Air jet loom

LDN 2020E 高速喷气织机，是拥有自主知识产权的多用途织机，该织机非常容易调整适应新产品！年生产能力可达20000台。

LDN 2020E high speed Air jet loom is the indepengently intellectual property multipurpose weaving machine.Easy to be regulated and the used for new products! The annual output can reach20000 sets.

专业

Professional

智能织机

Intelligent loom

遥控管理

Remote control management

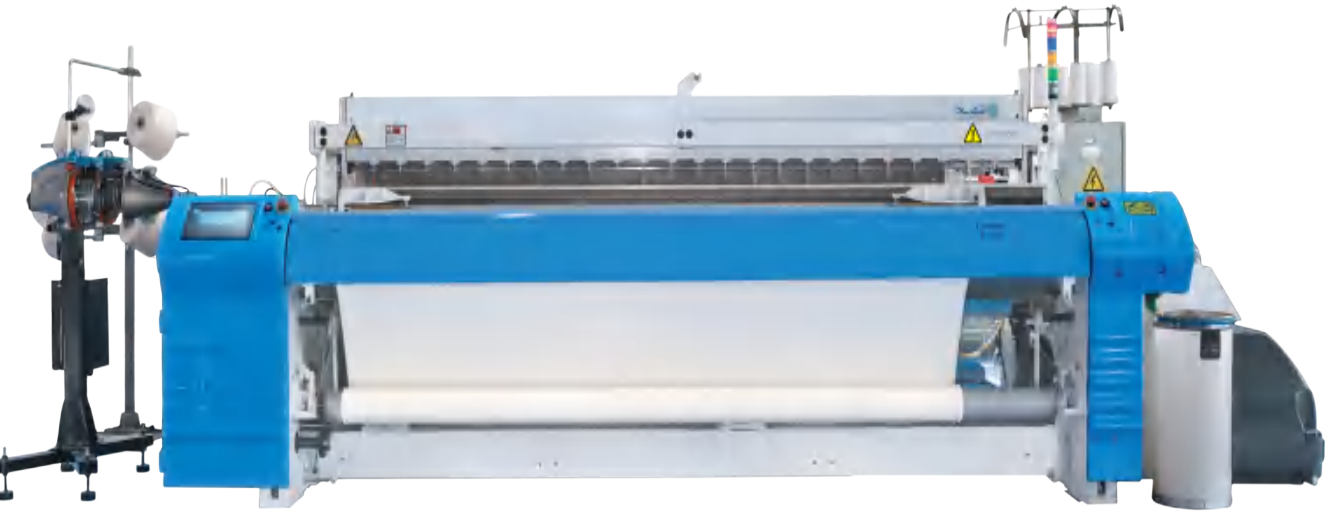

LND TN-i

喷气织造新基准

New benchmark in air-jet weaving

结合喷气织造近40年的经验和超过10万台喷气织机的使用，新款 **TN-i** 织机带着对未来清晰目标横空出世。

Combining nearly 40 years of air-jet weaving experience and the use of more than 100,000 air-jetlooms, the new TN-i weaving machine was born with a clear vision for the future.

在这瞬息万变的织造界，我们莱纳多人相信织造厂的总体需要及客户和其操作人员的期望也在快速转变。织造市场如今受到多种因素的驱动，即对环境问题的日益关注、高企的成本，稀缺的资源和技术工人，以及影响各行各业的数字革命。

In this rapidly changing world of weaving, we Lenado believe that the general needs of weaving mills and the expectations of customers and their operators are also changing rapidly.The weaving loom market is today driven by a combination of factors, namely, increasing concerns about environmental issues, high costs, scarce resources and technician, and the digital revolution affecting various industries.

基于此，**TN-i** 围绕我们的**几大设计原理**进行创新构建。

Based on this, TN-i is innovatively built around several of our design principles.

智慧性能 /INTELLIGENT PERFORMANCE

莱纳多织机一直都是，将来也会是以最佳性能为目标而设计，但是**智慧性能**却更强调即便在苛刻的条件下也能保证最高的工业速度。

Lenado weaving machines have always been designed for optimum performance, but **Intelligent performance** puts more emphasis on guaranteeing the highest industrial speeds even under demanding conditions.

我们的新款 **TN-i** 织机能够做到这一点，得益于**一种全新的打纬机构**：由于引纬时间更长，即使不那么完美的纱线在织造时也可游刃有余。

Our new TN-i weaving machine is able to do this thanks to a new beating-up: due to a longer weft insertion time, even less-than-perfect yarns can be woven with ease.

可持续性 /SUSTAINABILITY

进一步减少能耗，机器设计之初就要充分考虑的问题。由于**专利设计的气包和辅助喷嘴的间距经过调整**新款 **TN-i** 织机**引纬更加稳定，因此耗气量进一步减少**。

To further reduce energy consumption, the problem that must be fully considered at the beginning of machine design. Thanks to the patented design of the air bag and the adjusted spacing of the auxiliary nozzles, the new TN-i weaving machine is more stable in weft insertion, resulting in a further reduction in air consumption.

直观控制 /INTUITIVE CONTROLS

莱纳多织机的设计总是尽可能人性化。**TN-i**上的**全新大型交互式触摸屏**和**新型信号灯**将**直观控制**提高到了新的水平。客户能够快速轻松地浏览所有机器设置并在不停车的情况下进行调节。

Lenado looms are always designed to be as user-friendly as possible. A new large interactive touchscreen and new signal lights on the TN-i take intuitive control to a new level. Customers can quickly and easily browse all machine settings and make adjustments without stopping.

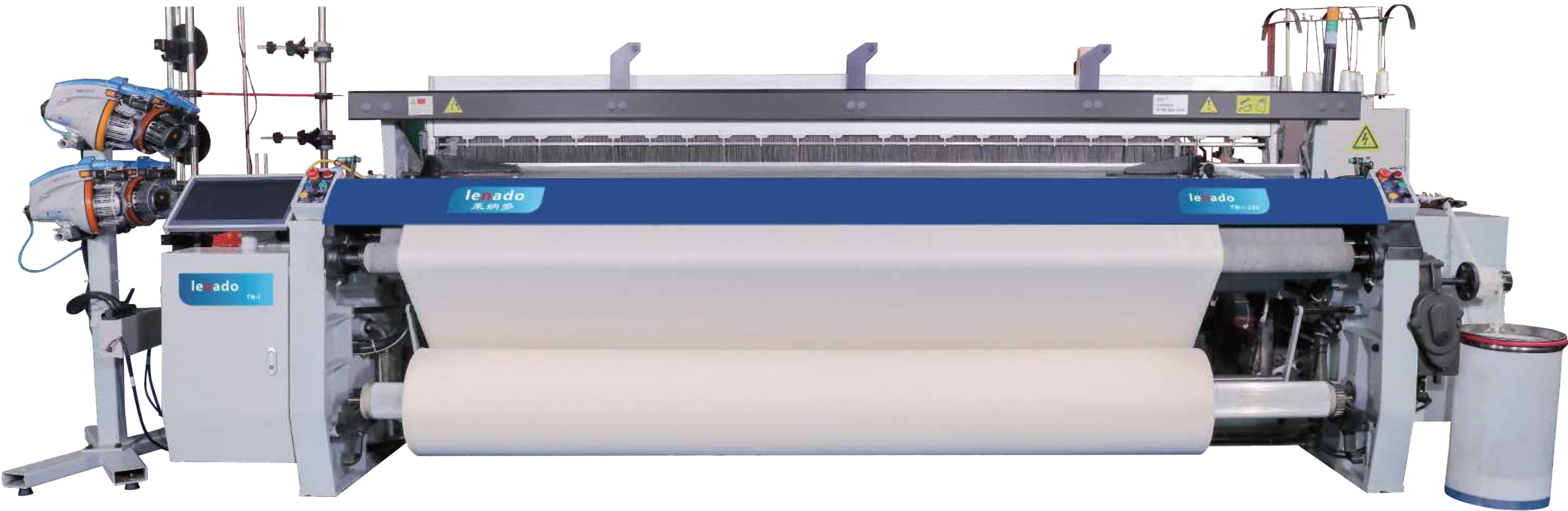

便捷的卷布辊更换方式

Convenient way to replace the cloth roller

独特的设计，给挡车工换轴落布带来无与伦比的**方便体验**。

The unique design brings unparalleled convenience for workers to change the shaft and drop the cloth.

每个通道单独设定优化引纬

Individual settings for each channel Optimizing weft insertion

独立气缸集成在织机墙板中：可通过一个电子气压调节器实现各个通道的最佳设定。

Independent cylinders are integrated in the weaving machine wall panel: the optimum setting of the individual channels can be achieved by means of an electronic air pressure regulator.

快速得出每个品种 所需的纬纱长度

Get each variety quickly
Desired weft length

储纬器的独特专利设计使纬纱长度的设置快速简便。储纬器设置完全电子化，大幅减少品种更换所需时间。

The unique patented design of the weft feeder makes setting the weft length quick and easy. The setting of the weft feeder is completely electronic, which greatly reduces the time required for variety changes.



智慧性能

INTELLIGENT PERFORMANCE



上新品种的最快方式

The fastest way to get new breeds

莱纳多**快速品种更换装置**的设计大大缩短了新品种的上机织造时间。

The design of the Lenado quick variety changer greatly reduces the on-machine weaving time of new varieties.

管理纬纱长度，更加智慧

Manage the weft length, smarter

储纬器独特的专利设计使得废纱调节尽可能快速简单。

The unique patented design of the weft feeder makes waste yarn adjustment as quick and easy as possible.

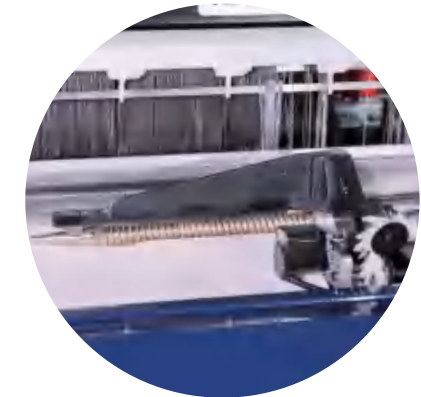

可持续性

SUSTAINABILITY



让机器自动调节，减少用电及耗气量

Let the machine automatically adjust to reduce electricity and gas consumption

可根据纬纱的特性和空气亲和度极其便捷调整辅喷阀的开启和关闭时间。

It is extremely convenient to adjust the opening and closing time of the auxiliary injection valve according to the characteristics of the weft yarn and the air affinity.



最节能的主驱动

Most energy efficient main drive

莱纳多运用的**变频调速马达（超级马达）**是最先进节能的驱动理念。作为一个集成系统设计，它实现了**尽可能低的能耗**，同时也提供了其他很多优势，如全范围速度控制、慢动、找纬等功能。

The variable frequency motor (Super Motor) used by Lenado is the most advanced and energy-saving drive concept. As an integrated system design, it achieves the lowest possible energy consumption, while also providing many other advantages, such as full range speed control, slow motion, weft finding and other functions.



优化耗气量所需的稳定性

Stability required to optimize air consumption

随着**专利气包设计和辅助喷嘴间距**的优化，引纬稳定性提升到了更高水平。这样就可以在不影响织物质量和机器停车水平的情况将耗气量降至最低。

With the patented air bag design and the optimization of the auxiliary nozzle spacing, the weft insertion stability has been raised to a higher level. This minimises air consumption without compromising fabric quality and machine shutdown levels.



进一步回收纬纱废纱

Further recycling of weft waste yarn

引纬结束时，纬纱被充分拉伸并导入吸嘴。然后，剩余的纬纱废纱被清除并回收。另外通过电子废边剪刀，大大减少了机修工的工作量。

At the end of weft insertion, the weft thread is fully stretched and guided into the nozzle. Then, the remaining weft yarn waste is removed and recycled. In addition, through the electronic waste edge scissors, the workload of the mechanic is greatly reduced.

超高度的数字化

Ultra-high level of digitization

先进的15吋互动彩色显示屏是一个新的平台，可以满足所有的需求和应用。

The advanced 15 o'clock interactive color display is a new platform that can meet all needs and applications.



驱动
DRIVE

电动过滤供油系统

Electric filter oil supply system

独特的**电动过滤供油系统**，保证了织机高速织造状态下的清洁润滑，延长了打纬单元的使用寿命。

The unique electric filter oil supply system ensures the cleaning and lubrication of the loom under high-speed weaving, and prolongs the service life of the beating unit.



可靠的电子控制平台

Reliable electronic control platform

SmartBox电子控制平台，其灵活性和可靠性更进一步。**数据收集**和**数据访问**为提高生产效率提供了全新的保证。

The SmartBox electronic control platform takes its flexibility and reliability even further. Data collection and data access provide a whole new level of assurance for increased productivity.



让机器智慧化

Make machines smarter

专利技术的传感器不断地将数据输入算法，以优化机器的织造性能。
Patented sensors continuously feed data into algorithms to optimize the weaving performance of the machine.

动动手指，即可对数据进行全面快速的访问和控制

Full and fast data access and control at the touch of a finger

使用**15吋大显示屏**可以**快速访问**和**控制所有设定**。机器中的所有运行相关数据。在**数字化程度最高**的机器上，**直观的界面**为市场设定了新的基准。

Use the large 15-hour display to quickly access and control all settings. All operational related data in the machine. On the most digitized machines, the intuitive interface sets new benchmarks in the market.



全数字化气压设定

Fully digital air pressure setting

独一无二！用户可以快速轻松地调整所有**气压设置**并可将其拷贝转移到其他机器上。

Unique! Users can quickly and easily adjust all air pressure settings and copy them to other machines.





享受织机操作

Enjoy loom operation

除了所有莱纳多织机上标配的各种**用户友好配置**外，更有一系列**创新设计**，操作机器变得更加容易。

In addition to the various user-friendly configurations that are standard on all Lenado weaving machines, there is a range of innovative designs that make operating the machine even easier.

 **直观控制**
INTUITIVE CONTROL

培训是莱纳多与客户之间所签订协议的一个组成部分

Training is an integral part of the agreement signed between Lenado and the customer



我们认为帮助您的员工提升技能和知识是我们的职责所在。为此，2015年我们在江苏省东台总部投建了一座配套先进的技术培训中心。

We believe it is our job to help your employees develop their skills and knowledge. To this end, in 2015, we invested and built an advanced technical training center at our headquarters in Dongtai, Jiangsu Province.

中心有三个设备齐全的培训室（每个培训室配有织机、切割和迷你车间等等），总占地面积。270平米这座新的培训中心使莱纳多可以在最佳条件下为来自世界各地的客户技师进行线上线下培训。

The center has three fully equipped training rooms (each with looms, cutting and mini workshops, etc.) covering a total area of 270 square meters. This new training center allows Leonardo to conduct online and offline training for customer technicians from all over the world under optimal conditions.

培训中心设施齐全，热情欢迎贵司人员的到来。

The training center is well-equipped and warmly welcomes the arrival of your staff.

LND TN-i 技术规格

LND TN-i Technical specifications

织物规格 /FABRIC		
有效幅宽 EFFECTIVE WIDTH	190,220,230,250,260,280,340,360,400 cm	
减幅 (包括对称和非对称减幅) EFFECTIVE WIDTH REDUCTION (INCLUDING SYMMETRICAL AND ASYMMETRICAL REDUCTIONS)	190cm： at least 70cm 220 and 250cm： at least 90cm 280、340、360 and 400cm： at least 96cm	
纱支范围 YARN COUNT RANGE	短纤 STAPLE FIBER	Nm 4-Nm 170,Ne2.4-Ne 100 10 denier-1000 denier,11 dtex-1100 dtex
	长丝 LONG FILAMENT	
引纬 /WEFT INSERTION		
纬纱选色 WEFT COLOR SELECTION	最多 8 色 UP TO 8 COLORS 双纬或多纬引纬（最多 8 纬） DOUBLE OR MULTIPLE WEFT INSERTION (UP TO 8 PICKS)	
储纬器 (集成式断筒纱传感器) WEFT FEEDER (INTEGRATED SENSOR FOR YARN BREAKAGE)	相邻纱圈 ADJACENT YARN LOOPS 分离纱圈 SEPARATING YARN LOOPS 储纬器自动切换功能 AUTOMATIC SWITCH FUNCTION OF WEFT FEEDER	
积极式纬纱张力器 POSITIVE WEFT TENSOR	程控纬纱张力器 PROGRAMMABLE WEFT TENSOR 气圈罩 BALLOON LIMITOR	
探纬 WEFT DETECTION	光电式，筘前式 PHOTOELECTRIC TYPE, REED FRONT TYPE 第二探纬器， 筘前式或锯筘式 SECOND WEFT PROBE, REED FRONT OR SAW REED	
纬纱剪刀 WEFT YARN SCISSORS	电子纬纱剪刀，各通道单独设定剪切时间 ELECTRONIC WEFT SCISSORS, EACH CHANNEL CAN SET THE CUTTING TIME SEPARATELY 换筒纱探测器 YARN CHANGE DETECTOR 莱纳多去结头装置 LENADO'S KNOT REMOVAL DEVICE 固定和摆动主喷嘴 FIXED AND OSCILLATING MAIN NOZZLE 辅助喷嘴 AUXILIARY NOZZLE	

送经 /LET-OFF	
经轴 BEAM	800,914，1000 或 1100mm 适用于 280 厘米及以上幅宽的双经轴 FOR DOUBLE BEAMS OF WIDTH 280 CM AND ABOVE
后梁 BACK-BEATER	通用型，内置经纱张力传感器 UNIVERSAL TYPE WITH BUILT-IN WARP TENSION SENSOR 平稳机构（自动经纱张力补偿） STABLE MECHANISM (AUTOMATIC WARP TENSION COMPENSATION)
停经装置 STOP DEVICE	6 根电子停经条，25 毫米节距或 8 根停经条，16 毫米节距 逐条探测 6 ELECTRONIC DROP BARS 25MM PITCH OR 8 DROP BARS 16MM PITCH DETECTION STRIP BY STRIP
快速更换品种装置 QUICK CHANGE BREED DEVICE	
卷取装置 /TAKE-UP DEVICE	
卷取装置 TAKE-UP DEVICE	布卷直径 ROLL DIAMETER 通过压布辊直接卷取 DIRECT TAKE-UP BY PRESSING ROLLERS
织机驱动和控制（SmartBox 平台） /LOOM DRIVE AND CONTROL (SmartBox platform)	
主马达 MAIN MOTOR	主马达直接驱动织机 THE MAIN MOTOR DIRECTLY DRIVES THE LOOM 智能变频控制车速 INTELLIGENT FREQUENCY CONVERSION CONTROL VEHICLE SPEED
全自动找纬 FULLY AUTOMATIC WEFT FINDING	
筘座运动 REED MOVEMENT	共轭凸轮，带凸轮从动件 CONJUGATE CAM,WITH CAM FOLLOWER
开口机构 SHEDDING	积极式多臂开口，最多可配 16 片综框 POSITIVE DOBBY SHEDDING FOR UP TO 16 SHAFTS HEALD FRAME 积极式凸轮开口，最多可配 8 到 10 片综框 POSITIVE CAM SHEDDING FOR UP TO 8 TO 10 HEALD FRAMES 带自动综平功能的凸轮机构 CAM MECHANISM WITH AUTOMATIC LEVELLING FUNCTION 适用 330 毫米（13 吋）综丝的综框 HEALD FRAMES FOR 330 MM (13 O'CLOCK) HEALD WIRE
电子送经和卷取系统 ELECTRONIC LET-OFF AND TAKE-UP SYSTEM	
中央润滑，自动将过滤润滑油高压循环至各个主要传动点润滑 CENTRAL LUBRICATION, WHICH AUTOMATICALLY CIRCULATES THE FILTERED LUBRICATING OIL UNDER HIGH PRESSURE TO EACH MAIN TRANSMISSION POINT FOR LUBRICATION	
互动式显示屏 INTERACTIVE DISPLAY	15 吋触摸屏 15' TOUCH SCREEN
综框 /HEALD FRAME	
加强型综框 ENHANCED HEALD FRAME	

布边装置 /SELVAGE DEVICE

电子控制独立布边装置
ELECTRONICALLY CONTROLLED INDEPENDENT SELVAGE DEVICE
折入边装置（机械或气动折入边装置）
TUCK-IN DEVICE (MECHANICAL OR PNEUMATIC TUCK DEVICE)

中央布边
CENTRAL SELVAGE

热熔剪刀
HOT MELT SCISSORS

全幅边撑
FULL WIDTH TEMPLS

监控工具和软件工具 /MONITORING TOOLS AND SOFTWARE TOOLS

织机监控和报告通过织机显示屏进行
WEAVING MACHINE MONITORING AND REPORTING VIA THE WEAVING MACHINE DISPLAY

各个主要织机监控系统的通用连接
UNIVERSAL CONNECTION TO ALL MAJOR LOOM MONITORING SYSTEMS

基于以太网或串行连接的双向通讯
BIDIRECTIONAL COMMUNICATION OVER ETHERNET OR SERIAL CONNECTION

法规 /REGULATIONS

在设计 *TN-i* 织机时，莱纳多充分考虑了当前有关安全（机械和电气）以及环境（人体工程学、噪音、震动和电磁兼容性）方面的国内及国际性法规。

When designing the TN-i weaving machine, Leonardo took into account current national and international regulations regarding safety (mechanical and electrical) and the environment (ergonomics, noise, vibration and electromagnetic compatibility).

LND2020E提花喷气织机

LND 2020E speed jacquard Air jet loom

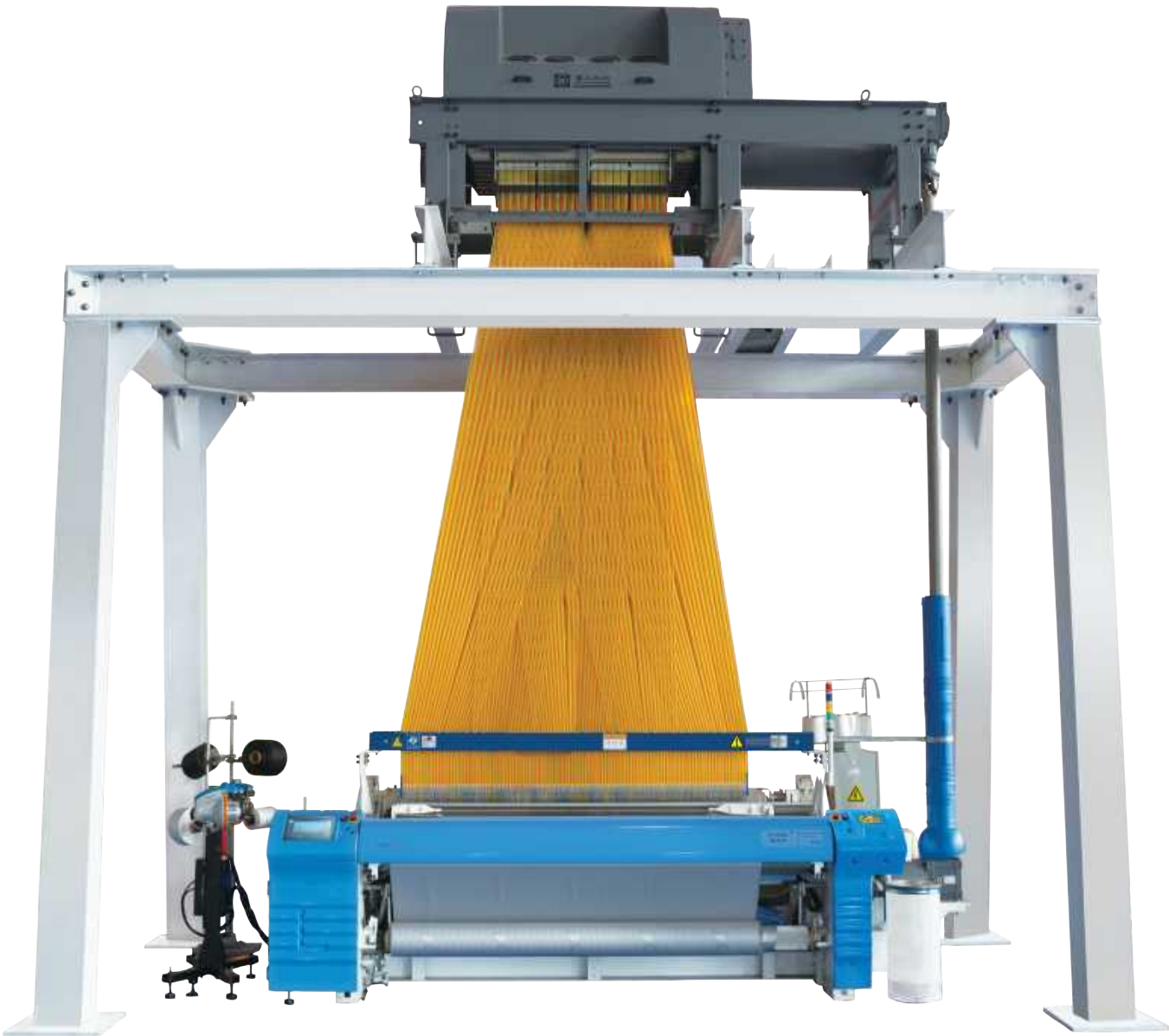

LND2020E 技术规格

LND 2020E technical specifications

项目 (Item)		规格 (specification)	备选件 (optional)
织机箱幅 Reed space	公称箱幅 (Nominal)	190、210、230、260、280、340、360cm	
	有效穿箱幅 useful reed width	公称箱幅减0~60cm (90~260cm) Same as nominal width Max reduction 60cm(190~260cm)	
		公称箱幅减 0~80cm (280~360cm) Same as nominal width Max reduction 80cm(280~360cm)	
织机车速 Speed		每分钟可达车速1200转 1200 rounds per minute	
选纬 Weft selection		2喷、4喷、6喷、8喷 2c、4c、6c、8c	
动力 Drive		超启动马达 Superstarting moter	
		按钮式启动、停车、正反转缓慢运动 Direct drive stop by electromagnet brake	
引纬 Weft insertion		主副喷嘴并用式 Main and sub-nozzles combined system	拉伸喷嘴 Stretch nozzle
		辅助主喷嘴 Auxiliary main nozzle	
		异型钢筘 Profiled reed	
开口 Shedding		积极凸轮开口：综框10页 Positive cam: shaft up to10	
		多臂开口：综框20页 Dobby: shaft up to 20	
		电子提花开口： electronic jacquard ø800mm	
送经 Let-off	边盘直径 Flange Dia	伺服电子送经 Servo electronic let-off	
		积极松经 Positive easing	
卷取 Take up		伺服电子卷取 Servo electronic take-up	
	最大卷布直径 Max take up Dia.	ø600mm	机外卷可达ø1500 Outer coiling of the machine 1500mm
	纬密范围 Pick density	9.8-118根/厘米 9.8-118 picks/cm	
	织布长度计数 Length count	触摸屏显示布长、定长停车 board display, fixed meassure stop	
	边撑器 Side brace	上置式 overhead	
打纬 Beating		曲柄打纬 Crank beating	
		4连杆打纬 (190-280cm)	
		4links (Read space 280cm)	
		6连杆打纬 (280-360cm)	
		6links(Read space 280cm)	
纬纱架 Filling Supply Stand		配置摇轴中间支撑 intermediate rocking supporter	
		落地式4筒纱 (2喷) , 8筒纱 (4喷) , 10筒纱 (6喷) Floor-mounted for 4packages(2c),for8(4c)for10(6c)	
纬剪 Cutter		机械剪刀 Mechanical cutter	
润滑 Lubrication		主动传动部分油浴方式、集中加油 (黄油手动) Oil bath system for main drive parts, centralized lubrication(manual grease)	电动集中加油 electric centralized lubrication
停车装置 Auto stop Motion	断纬 Weft broken	光电反射式探纬器 Reflective weft feeler	
	断经 Warp broke	六排电器接触式 Six rows Electric fleeling system	
	其他 Others	绞边纱、纱端处理端头停车 Stop for selvage and catch cord yarn	
	停经原因显示 Stop cause indication	触摸屏显示, 多功能四色灯停车显示 Message on board, 4-colors lamp for indicating cause	
中间剪刀 Middle scissors		机械式 (双幅式时) Mechanical type (Tisser double width)	电子式 Electric type

此款新型高档喷气织机可织制2至8色不同纬
纱服装面料，墙布，酒店布草以及玻璃纤维等多
种装饰及工程用布。

This new high-end air jet loom can weave
2 to 8 colors of different weft clothing fabrics,
wall cloth, hotel linen, glass fiber and other
decorative and engineering fabrics.

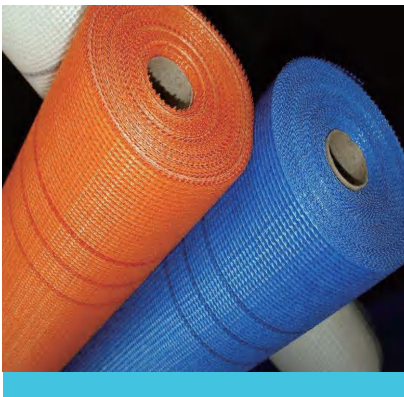
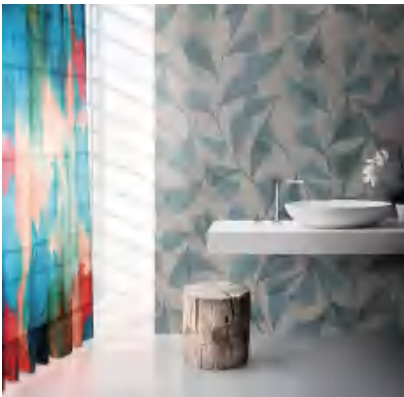
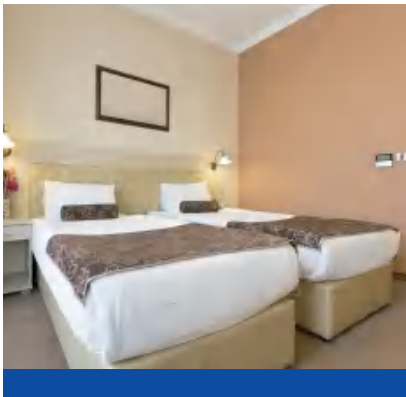

公司一角

A PART OF THE COMPANY

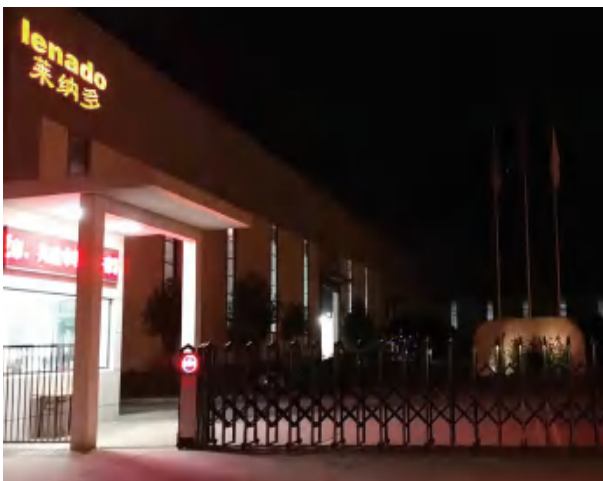

加工设备

PROCESSING EQUIPMENT



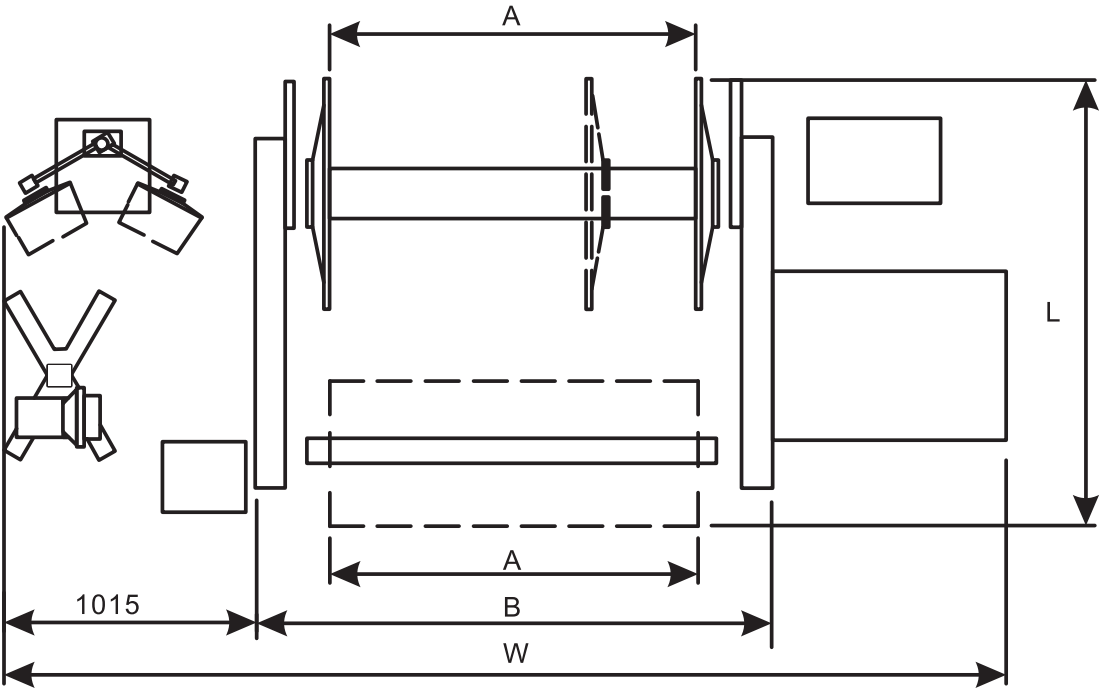
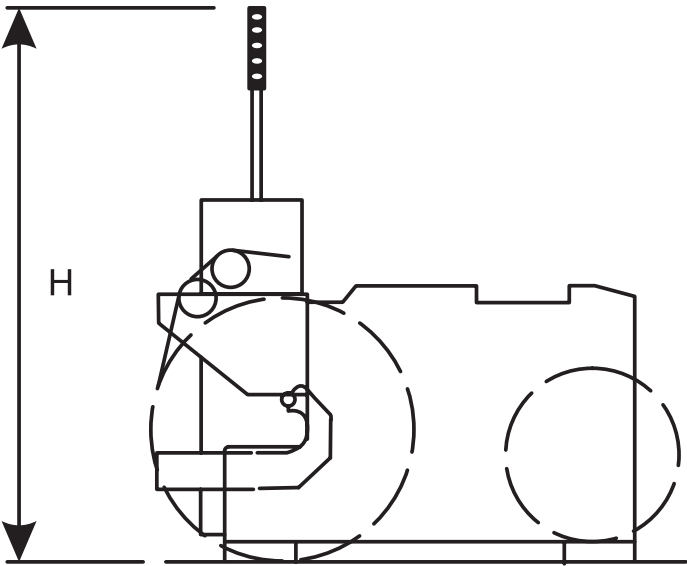

公称笳幅称 (cm) Nominal reed size (CM)		150	170	190	210	230	250	280	340	360	390
W	曲柄开口 (3.0KW) Crank opening (3.0KW)	3,810	4,010	4,210	4,410	4,610	4,810	5,110	5,710	5,910	6,210
	积极凸轮 Positive CAM	4,085	4,285	4,485	4,685	4,885	5,085	5,385	5,985	6,185	6,485
	下置式积极多臂 The type of positive dobby	4,239	4,439	4,639	4,839	5,039	5,085	5,539	6,139	6,339	6,639
A		1,500	1,700	1,900	2,100	2,300	2,500	2,800	3,400	3,600	3,900
B		2,110	2,310	2,510	2,710	2,910	3,110	3,410	4,010	4,210	4,510

	边盘直径 Diameter of side plate	曲柄/凸轮 Crank/Cam	多臂 Dobby
L	Φ800	1,762	1,882
	Φ914	1,828	1,948
	Φ1,000	1,894	2,014
H		2,014	
L	Φ1100	2,016	2,136
H		2,056	

注：

- 1.有关其他规格等的详细说明，请向我公司咨询；
- 2.边盘直径在914以上时，需加高织机，或将经轴下方地面下沉；
- 3.此样本所载尺寸，本公司有在未预告的情况下进行改进的权利，请予理解。

Note:

- 1. For details of other specifications, please consult our company;
- 2. When the diameter of the side disc is above 914, it is necessary to raise the loom or sink the ground below the warp shaft;
- 3. Please understand that we have the right to improve the size of the sample without prior notice.